

IMPORTANT INSTALLATION INSTRUCTIONS FOR:

W-DD Wood fitting dog door suitable for wood panels 5-36mm

An appropriate template is supplied for this model

MEASURING AND MARKING THE LOCATION OF YOUR WOOD FITTING PET DOOR

Measure the belly (stomach) height of your pet. Dogs vary greatly so it needs to be a height that your dog can access easily. Belly height is the guide along with practicality of location.

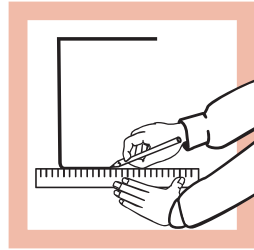
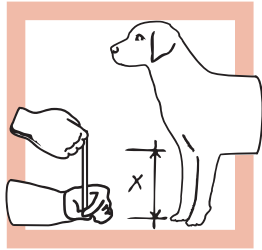

Position the template at the appropriate height with the bottom of the pet door level (where practical) with the pet's stomach. Tape the template to the door or panel that you are installing into. Ensure the template is level. With a pencil trace the line to be cut.

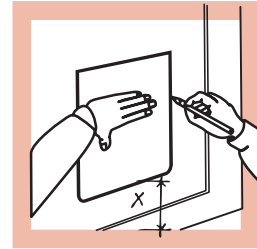

Drill four 10mm holes in the corners as per the diagram shown, making sure that the corners are the centre point of the hole.

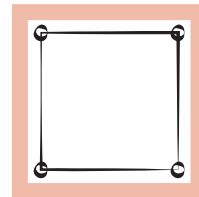

Carefully cut along the marked lines that you have marked around the template. You will end up with the shape as shown.

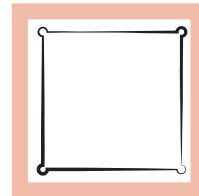

Do not install a pet door in any area leading directly into a pool.
Check with your local council.



W-DD Wood fitting dog door installation instructions (cont)

Slip the external pet door frame (main body) into the hole from the outside. Next slip the internal frame over the external main frame. This is a slip joint, which allows the frame to be compressed to fit the door thickness.

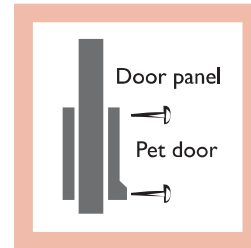

Ensure the screws provided are cut to the correct length. The correct length is door panel thickness plus 12mm.

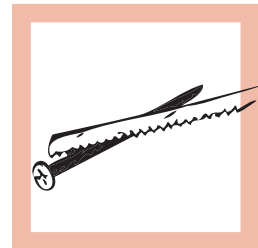

Now screw the internal and external frames together.

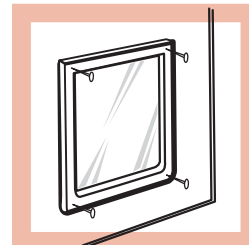

ADDITIONAL SECURITY FOR THE WOOD FITTING DOG DOOR

The wood fitting dog door has a security cover which can be used when additional security is required. The security cover is designed to be used when the door is in the fully locked position.

